

1 Join an upright profile (180 cm) and a cross profile (85 cm) with the appropriate screws

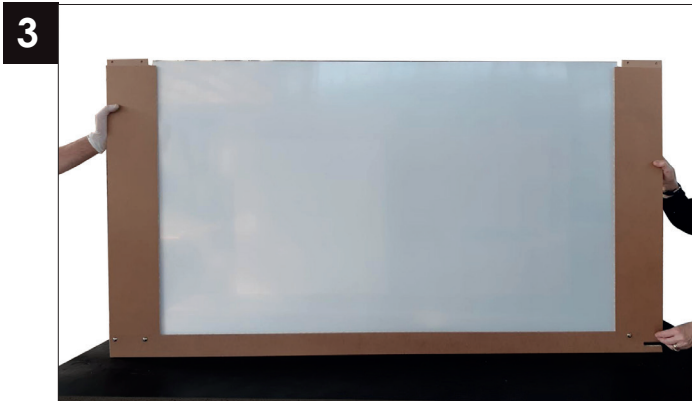

2 Insert the plexiglass sheet into the internal groove



3 Join the other cross profile (85 cm) with the appropriate screws



4 Fix the second upright profile (180 cm) with the appropriate screws



5 Insert the 2 feet in the grooves located at the base of the panel



6 Rotate the panel into a vertical position onto the 2 feet and remove the protective film from both sides of the plexiglass sheet

Easy to clean

Use a soft cloth to clean the Petalo Lisocore structure

HOW TO CLEAN PLEXIGLASS SHEETS

How



Use a soft, clean cloth or sponge



Soap or neutral detergent and warm water or antistatic liquid product

Avoid



Dry cleaning methods, using rough cloths



Cleaning agents that contain trichlorethylene, alcohol, benzene and solvents

WHY?

To avoid scratching the surface of the Plexiglass sheets and changing their appearance